

Approximate Size

Worth triangle rings are made of non-tempered steel and are often used as a connector between a key ring and a key fob. They are shipped in an "open" position to facilitate assembly, and must be crimped closed after assembly. They are available in six sizes in both nickel plate and zinc plate.

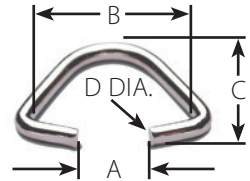

OPEN TRIANGLE RINGS
(NON-TEMPERED STEEL)

Triangle Rings

Size	3/8"	7/16"	1/2"	5/8"	3/4"	7/8"
"A" Dimension	.170 in / 4.32 mm	.197 in / 5.00 mm	.230 in / 5.84 mm	.260 in / 6.60 mm	.321 in / 8.15 mm	.375 in / 9.53 mm
"B" Dimension open	.375 in / 9.53 mm	.418 in / 10.62 mm	.491 in / 12.47 mm	.625 in / 15.88 mm	.750 in / 19.05 mm	.875 in / 22.23 mm
"B" Dimension Closed	.248 in / 6.30 mm	.290 in / 7.37 mm	.358 in / 9.09 mm	.450 in / 11.43 mm	.500 in / 12.70 mm	.575 in / 14.61 mm
"C" Dimension	.467 in / 11.86 mm	.550 in / 13.97 mm	.610 in / 15.49 mm	.700 in / 17.78 mm	.846 in / 21.49 mm	.956 in / 24.28 mm
"D" Diameter	.072	.072	.072	.082	.092	.092
Weight Per Thousand	1.28 lb / .58 kg	1.54 lb / .70 kg	1.94 lb / .88 kg	2.71 lb / 1.23 kg	4.07 lb / 1.85 kg	4.66 lb / 2.11 kg
Nickel-Plated Steel	94293	94290	94294	94295	94296	94297
Cost Per Thousand	\$18.80	\$20.35	\$21.35	\$30.35	\$48.25	\$55.85
Zinc-Plated Steel	94263	94260	94264	94265	94266	94267
Cost Per Thousand	\$18.80	\$20.35	\$21.35	\$30.35	\$48.25	\$55.85

Packaging: Bulk

Quantity Discounts (per size & finish): 5M-9M less 5%, 10M-24M less 10%, 25M-49M less 15%, 50M-99M less 20%, 100M-499M less 25%, 500M-999M less 30%, 1MM-Over less 35%



WARNING: This product can expose you to chemicals including nickel and lead, which are known to the State of California to cause cancer and birth defects or other reproductive harm. For more information, visit www.P65Warnings.ca.gov